



CARE & MAINTENANCE

Thank you for choosing our material. We are delighted to welcome you to experience the joy of living around GEOLUXE®. It's our pleasure to provide you some practical information with guidelines for Care & Maintenance to ensure that your GEOLUXE® countertop is best used in a proper manner and maintain its long-lasting beauty as well as values to stand the test of time.

CONTENTS

INSTRUCTION OF USE	4
Heat resistance	5
Stain resistance	6
Acid resistance	7
Impact resistance	8
Scratch resistance	9
GEOLUXE® for outdoor use	10
GUILDLINE FOR CARE & MAINTENANCE	12
Precautions about cleaning	13
Everyday care	13
Cleaning stubborn stains	14
Recoating	22
Chip repair	23
Scratch removal	24

INSTRUCTION OF USE



Kitchen has become vitally important nowadays firstly because it is a dream space for family's day-to-day living. A place where health meets wealth in harmony. A well-thought kitchen is a good investment as well as the jewel of home that fuels our bodies, minds and souls through various activities and where we cherish the joyful moments with beloved friends and family.

Since there is not any single day in life we may avoid coming into the kitchen, let's make it fun while pampering the healthy lifestyle with the right kitchen. Making a proper selection of countertop plays its part at this point as hygiene is, above all, very crucial not yet to mention the durability and its easy care and low maintenance efforts.

In order to ensure the material's performance at the fullest, please read carefully the instruction of use and follow the proper recommendations for the long-lasting beauty of your kitchen space and pleasure at all times.

■ HEAT RESISTANCE

GEOLUXE® countertop is resistant to heat to a remarkable extent but kindly pay special attention and be careful with the thermal shock issue. Here are some practical guidelines when using heated cookware on GEOLUXE® countertop. In case of installation of a firepit and BBQ grill, the guideline is provided at www.geoluxe.com.

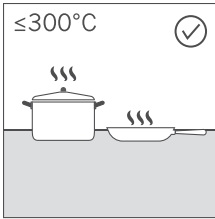

Place stainless or cast iron pot/pan ($\leq 300^{\circ}\text{C}$) comfortably on GEOLUXE® without discoloration or scorch mark issues.

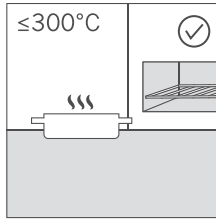

Place hot casserole ($\leq 300^{\circ}\text{C}$) comfortably on GEOLUXE® without discoloration or scorch mark issues.

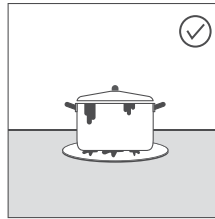

Use trivet to avoid dirty stain on countertop's surface and any unexpected damage from thermal shock.

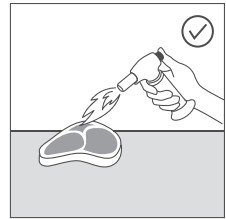

Blow torch back and forth at the food with appropriate flame adjustment.

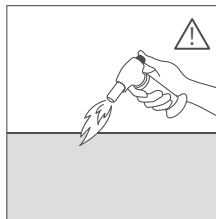

Do not keep naked flame constantly in direct contact at single spot.

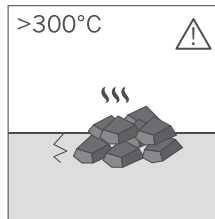

Do not keep hot objects over 300°C directly on the countertop's surface and avoid constant heat over time.



Heat can damage a countertop generally in 2 ways: discoloration or scorch marks and thermal fracture. Being material without resin, GEOLUXE® is definitely resistant to scorch mark but thermal fracture caused by the fast and rapid temperature fluctuation so-called "thermal shock" may occur like in other materials. However, it does not happen easily. Using GEOLUXE® as instructed is provable fine according to our simulation in which standard conditions are controlled, given that the addressed temperature of 300°C (570°F) shall naturally drop over time.



Scorch marks and stains (generated by burning dirt under utensils or food torch) sometimes might make a confusion because of their similar color. With GEOLUXE®, the marks should be stains. Simply try to clean them off with a soft damp cloth and mild soap, rinse then dry it properly.

■ STAIN RESISTANCE

GEOLUXE® is resistant to household common stains caused by normal daily living and use, provided that any stain is cleaned immediately or as soon as figured out, within 24 hours. Simply use a soft damp cloth to wipe your GEOLUXE® surface with warm water, followed by a dry cloth or paper towel to dry it up. The longer the stain is leftover on the surface, the harder it is to remove. In this latter case, it is still cleanable but will require a little more time and efforts. Please read carefully and follow the directions given in the “Cleaning Stubborn Stains Section”.



Remove any kind of stains and liquid spills on the surface **within 24 hours.**

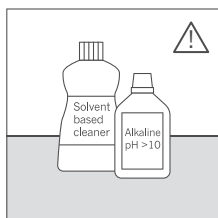

Do not use Acetone, solvent-based cleaner (cleaner with strong unpleasant odor) and alkaline solution with pH higher than 10.



Material with higher porosity is technically easier to get stained and thus harder to remove. GEOLUXE® is different thanks to its highly dense and very low porosity. However, it is not a stain-proof product, and so may get stained under improper circumstances, yet still cleanable but may require more time and efforts. In addition, GEOLUXE® is treated with in-line nanocoating to enhance its shininess and stain resistance performance suitable for all intended-use conditions. The durability of such protective layer may vary depending on usage conditions. It will considerably last longer when solvent-based cleaner is avoided.

■ ACID RESISTANCE

GEOLUXE® is resistant to almost all acid fluids. This allows you to enjoy cooking without worry on the countertop when having some ingredients with acidic splashes (i.e. lemon and vinegar) and even when necessary to clean the surface with household acid cleaner.

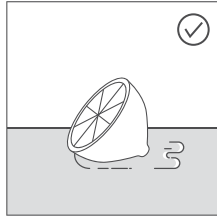

Resistant to acidic splashes from food ingredients.

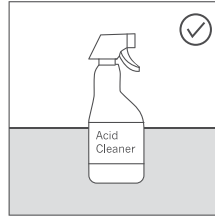

Able to use household acidic cleaner on GEOLUXE® surface.



Acid mostly attacks calcium-based material (e.g. Marble) and resin-mixed material (e.g. engineered quartz). Without both in composition, GEOLUXE® is accordingly safe from daily household acid.

■ IMPACT RESISTANCE

GEOLUXE® can withstand a lot of weight. Generally, kitchen equipment and utensils can be placed on GEOLUXE® without any problem; however, it is not an indestructible product. As with any surface, GEOLUXE® may crack by improper use. Please follow the details below.

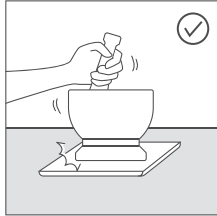

Better put soft cloth or silicone pad under mortar or pestle to prevent noise disturbance.

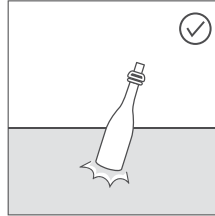

Accommodate the impact from a dropping object in the center to a certain degree.

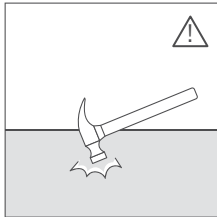

Do not hit your GEOLUXE® countertop with heavy and/or sharp objects.

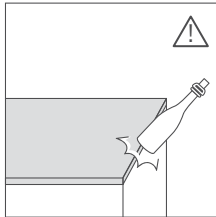

Do not hit your GEOLUXE® around the edge, cut-out hole and corner where chip could possibly occur.

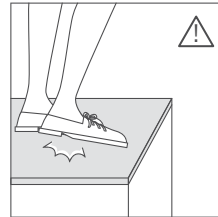

Do not step on the countertop.



The degree of Impact Resistance relies a lot on the area and impact angle where the material is hit by force. The thinner or smaller area, the higher chance of damage. Therefore, be very careful when using heavy or sharp object around the sink cut-out, corner and along any edge.



Chip, once happened, can be repaired as advised in Chip Repair section.

■ SCRATCH RESISTANCE

In daily household living, GEOLUXE® does not get scratched easily. However, like other materials, whether or not GEOLUXE® can resist to scratch mark depends on the type of material that comes into contact. To keep your GEOLUXE®'s surface shiny and free from scratches as long as possible, here are our advices.



Use plastic, glass and stainless-steel utensils.

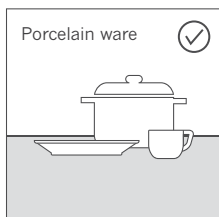

Gently use porcelain ware (beware of its unglazed rough bottom which might cause the hairline scratch if dragging)

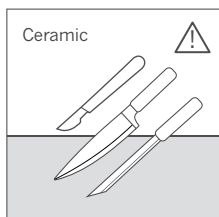
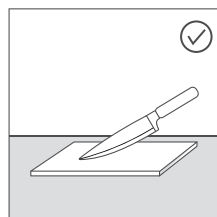

Do not use ceramic knives and sharp tools.

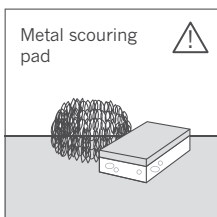

Do not use metal and heavy duty scouring pads.

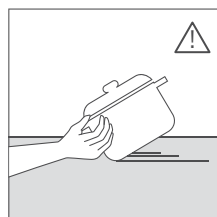

All materials get scratched when in touch with an object of the same or higher hardness. Likewise, GEOLUXE® is not a scratch-proof product, but it does not get scratched easily. In case hairline scratch is found, please contact the professional and follow the instruction, how to remove hairline scratches on polished surface, which can be found in Scratch Removal section.



Metal mark (grey line) may resemble scratch but it is actually a kind of residues from metal rubbed against the surface, and can be easily removed (see Cleaning section).

■ GEOLUXE® FOR OUTDOOR USE

Lots of concerns may come to your mind when thinking of outdoor kitchen. Whether it is durable enough to stand for harsh outdoor environment such as the swing climate throughout seasons, the strong sunlight and particular stains different from indoor kitchen. Whether it is too difficult and requires too much effort to take care of. GEOLUXE® realizes these kinds of concerns, and makes it easier. However, some uncontrollable factors might inevitably affect its quality over time. Therefore, please make sure you understand the fact and follow the instruction of use in order to keep your outdoor kitchen countertop long lasting as it possibly can.

First of all, a good quality of outdoor kitchen countertop starts with its proper installation. Please ensure that your fabricator understands well how to install GEOLUXE® properly in outdoor space. The guideline is available on the website, www.geoluxe.com.

DURABILITY

GEOLUXE® is weather and UV resistant. Its surface neither turns yellow nor is damaged by sunlight. Its glossiness also remains the same. It withstands the weather throughout all seasons. In other words, GEOLUXE® is fit for both semi-outdoor and outdoor use.

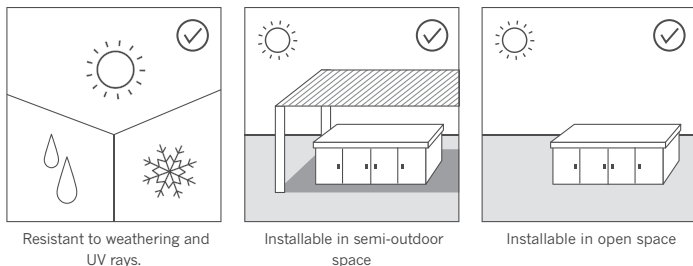

STAIN RESISTANCE

Stain resistance of GEOLUXE® remains the same no matter where it is used. Not only food stains but also the stains particularly found in outdoor context such as hard water stain, bird droppings, tannin from fermented leaves and dead insect are simply cleanable within 24 hours. As mentioned earlier, in case the stains are left over 24 hours, probably more likely to happen in outdoor use, and cannot be removed by the simple way, special removal techniques provided in Cleaning Stubborn Stain section are required.

In order to make it easier for cleaning and promote hygiene for each time of use, even though GEOLUXE® is stain resistant, following is the guideline to prevent dirt accumulation and make life easier.

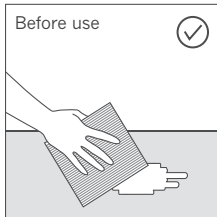

Before use
Clean off the outdoor stains before use. Cleaning Stubborn Stain method may be required.

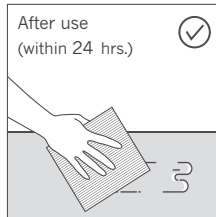

After use (within 24 hrs.)
After use, always clean GEOLUXE® within 24 hours.

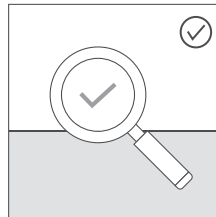

Periodically check and clean
Periodically check and clean the surface to get rid of accumulated dirt.

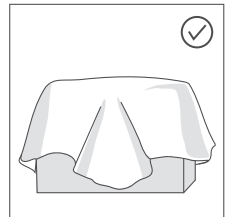

If not going to be used for a long period of time, better keep it covered with waterproof vinyl sheet.

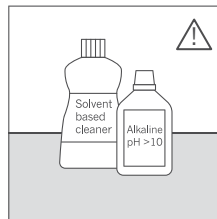

Do not use Acetone, solvent-based cleaner (cleaner with strong unpleasant odor) and alkaline solution with pH higher than 10.



In general, UV and stain resistances in outdoor use have their lifespan to perform as perfectly as original. The key factors towards their performance are how harsh the outdoor environment is and how well the countertop is used and taken care of. For instance, strong sunlight and heavy rain alternately all the time accelerate the drop of performance whereas mild climate all year round does not affect it significantly. As a result, when time goes by, some stains are getting harder to remove after being left for long, which is probably noticed generally after use more than 5 years.



Hard water stain from rainwater seems the most problematic for all materials when leaving the countertop outside since it contains the high concentration of dissolved minerals which can deposit on the surface once dried up. This stubborn stain can be removed using the method specified in Cleaning Stubborn Stain section.

Simply have your GEOLUXE® countertop recoated by the professionals to get it renewed properly every 5 years. How to recoat is found in Recoating section.

GUIDELINE FOR CARE AND MAINTENANCE



Basically, a GEOLUXE® countertop is easy to clean. Food stains, outdoor stains can be simply removed. Just in some cases, special care is required especially when stains are left over for too long or when some accidents may occur and cause damages to the slab like chips and scratches.

Following are our advices how to deal with the problems right after an incident unintentionally happens.

■ PRECAUTION ABOUT CLEANING

CHEMICALS TO AVOID

To maintain the sheen of all finishes and keep the performance long lasting, it is recommended NOT to use following cleaning agents to clean the surface.

- **Acetone** and any solvent-based cleaner
e.g. thinner, turpentine oil, etc.
- Alkaline solution with **pH higher than 10**
e.g. ammonia, caustic soda, sodium hypochlorite
- **Glass etching acid** or hydrofluoric acid (HF)
- **Abrasive cleaner**

TOOLS TO AVOID

It is recommended not to use following tools to clean GEOLUXE®'s surface.

- **Metal** scouring pads
- **Heavy** duty scouring pads

■ EVERYDAY CARE

GENERAL CLEANING

For your hygiene and staining prevention, it is recommended to remove any kind of liquid remained on GEOLUXE® surface **within 24 hours**. The stain should be cleaned easily. Just simply follow below steps.

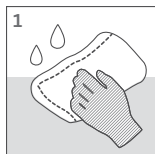

1 Simply use a soft damp cloth to wipe your GEOLUXE® surface with warm water

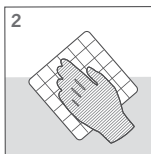

2 Wipe with a dry cloth or paper towel for more cleanliness

In case of oil stain (including any fat), using a soft damp cloth to wipe your countertop with mild soap and warm water, then rinse with clean water and dry with paper towel or soft cloth.

For honed surface, it requires more daily maintenance than the polished finish. Once found, the stain should be cleaned out immediately. Fingerprints and other signs of daily living are more visible. Most of the stains can be easily removed with the same method as the polished surface, but soft brush may be used for better stain removal. Apply a small amount of warm water or mild detergent on stains, rub with soft brush until stain comes out, then rinse with water and clean with dry cloth.

■ CLEANING STUBBORN STAIN

If the liquid spills remain on the surface for a long period of time, they sometimes can become stubborn stains which cannot be removed by only using general cleaning method. Utilizing stubborn stains cleaning method will help you clean each kind of stain much more easier.



1. FOOD & SOAP STAIN

: coffee/tea, red wine, soft drink, fruit juice, mustard, cooking oil, any fat, tomato sauce, soy sauce, BBQ sauce, food burnt and soap.

Tools: soft cloth/ paper towel, gloves for your protection, cotton pad and sticky tape (if required)

Recommended cleaning agents: Multi-purpose cleaner (e.g. Mr.Clean: Multi-purpose Cleaner, Vixol Oxy)

HOW TO CLEAN?

Try simple step first. If the stain persists, please try the advanced step.

: SIMPLE STEP

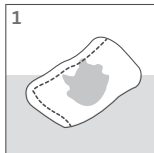

1 Apply the recommended cleaning agent on a soft damp cloth (do not pour directly on the countertop to prevent spill out)



2 Gently rub the surface until the stain is completely gone

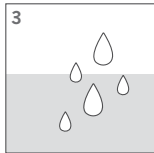

3 Rinse with clean water

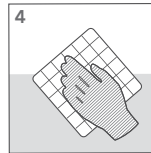

4 Completely dry with kitchen paper towel or soft dry cloth

: ADVANCED STEP

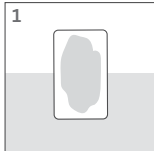

1 Saturate the cotton pads or paper towels with the recommended cleaning agent

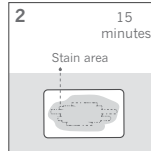

2 Place it on the stain area and soak for **15 minutes**

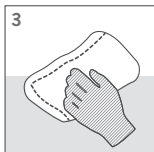

3 Gently rub the surface with soft damp cloth and check the result

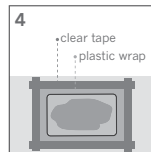

4 If the stain persists, continue to soak with longer time and cover the cotton pad with plastic wrap and clear tape to prevent evaporation (some stubborn stain may need up to 48 hours of soaking)

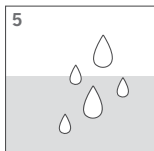

5 After the stain is removed, rinse thoroughly with clean water

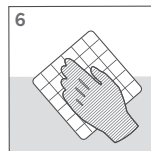

6 Dry with paper towel or soft dry cloth

Remark: During soaking, you can open and check the visibility of stain every couple of hours. After 48 hours, if the stain still remains, please contact our customer service for further assistance.



- DO NOT use high alkaline solution (pH > 10) for soaking method. Instead, please strictly use the cleaning agent as recommended.
- If recommended cleaning agent cannot be found in your area, be sure to test available product on small area of GEOLUXE™s surface before use.

2. LIMESCALE, HARD WATER STAINS AND RUST MARK

Tools: soft cloth/ paper towel, gloves for your protection, cotton pad and sticky tape (if required)

Recommended cleaning agents: Acid detergent (e.g. Zep: Calcium, Lime and Rust Stain Remover)

HOW TO CLEAN?

Try simple step first. If the stain persists, please try the advanced step.

: SIMPLE STEP

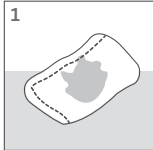

1 Apply the recommended cleaning agent on a soft damp cloth (do not pour directly on the countertop to prevent spill out)

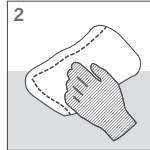

2 Gently rub the surface until the stain is completely gone

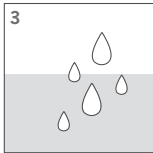

3 Rinse with clean water

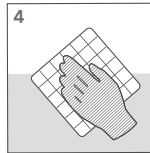

4 Completely dry with kitchen paper towel or soft dry cloth

: ADVANCED STEP

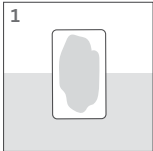

1 Saturate the cotton pads or paper towels with the recommended cleaning agent

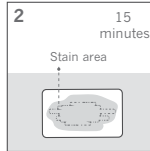

2 Place it on the stain area and soak for **15 minutes**

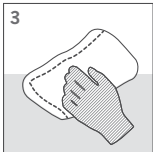

3 Gently rub the surface with soft damp cloth and check the result

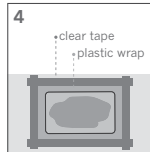

4 If the stain persists, continue to soak with longer time and cover the cotton pad with plastic wrap and clear tape to prevent evaporation (some stubborn stain may need up to 48 hours of soaking)

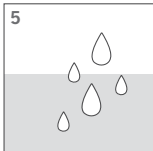

5 After the stain is removed, rinse thoroughly with clean water

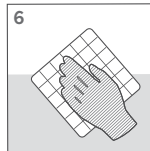

6 Dry with paper towel or soft dry cloth

Remark: During soaking, you can open and check the visibility of stain every couple of hours. After 48 hours, if the stain still remains, please contact our customer service for further assistance.



- DO NOT use high alkaline solution (pH > 10) for soaking method. Instead, please strictly use the cleaning agent as recommended.
- If recommended cleaning agent cannot be found in your area, be sure to test available product on small area of GEOLUXE®'s surface before use.

3. METAL MARK

Tools: Soft cloth/ paper towel, gloves for your protection

Recommended cleaning agents: Metal polish cream/liquid (e.g. Brasso: Metal Polish, Weno: Metal Polish)

HOW TO CLEAN?

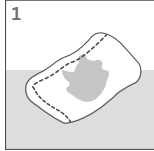

Apply the recommended cleaning agent on a soft damp cloth (do not pour directly on the countertop to prevent spill out)

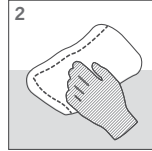

Gently rub the surface until the stain is completely gone

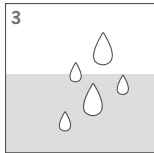

Rinse with clean water

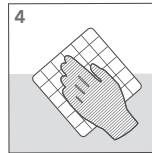

Completely dry with kitchen paper towel or soft dry cloth

Remark: If the stain still remains, please contact our customer service for further assistance.



Metal mark may resemble scratch, but it is actually a residue from metal rubbed against the surface and can be easily removed.

4. GREASE, CANDLE WAX, EPOXY AND PARAFFIN

Tools: Soft cloth/ paper towel, gloves for your protection, cotton pad

Recommended cleaning agents: Epoxy grout haze and coating stripper (e.g. Stonetech: Epoxy Grout Haze & Coating Stripper)

HOW TO CLEAN?

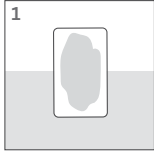

1 Saturate the cotton pads or paper towels with the recommended cleaning agent

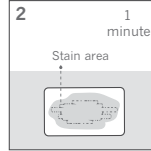

2 Place it on the stain area and soaked for **1 minute**

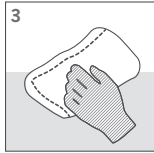

3 Gently rub the surface with soft dry cloth

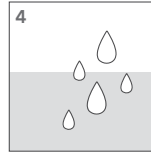

4 Rinse thoroughly with clean water

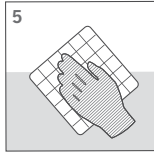

5 Completely dry with paper towel or soft dry cloth

Remark: If the stain still remains, please contact our customer service for further assistance.



DO NOT place Epoxy grout haze & coating stripper on the surface more than 5 minutes. It can affect stain resistance property.

5. HOUSEHOLD GLUE

: water glue, glue stick, Latex glue and sticky tape

Tools: Soft cloth/ paper towel, an eraser

Recommended cleaning agents: Multi-purpose cleaner (e.g. Mr.Clean: Multi-purpose Cleaner, Vixol Oxy)

HOW TO CLEAN?

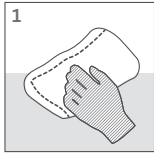

1
Due to its stickiness, try to rub it out with clean soft cloth or even an eraser

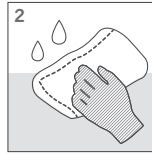

2
If the stain is already dried, soften it with clean damp cloth and rub it again.

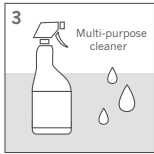

3
If there remains a small leftover, it is recommended to use Multi-purpose cleaning agent to rub it and rinse with water.

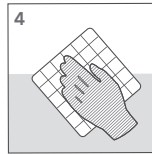

4
Do not forget to dry it after rinsing.

Remark: If this kind of stains still persists or there are other kinds of glues (e.g. super glue, silicone) sticking on the surface, please contact our customer service for further assistance.



Naturally, the longer sticky stains remain on the surface, the harder they would be to remove.

6. COSMETICS

: foundation, BB cream, brush on, eyeshadow, eyeliner, mascara, lipstick

Tools: Soft cloth/ paper towel, gloves for your protection, cotton pad and sticky tape (if required)

Recommended cleaning agents: Multi-purpose cleaner (e.g. Vixol Oxy)

HOW TO CLEAN?

Try simple step first. If the stain persists, please try the advanced step. Most of cosmetic stains can be easily removed with simple way using just warm water.

: SIMPLE STEP

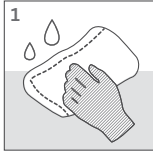

1 Simply use a soft damp cloth to wipe your GEOLUXE® surface with warm water

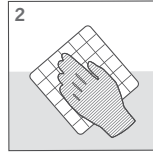

2 Wipe with a dry cloth or paper towel for more cleanliness

: ADVANCED STEP

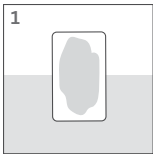

1 Saturate the cotton pads or paper towels with the recommended cleaning agent

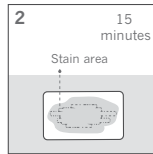

2 Place it on the stain area and soak for **15 minutes**

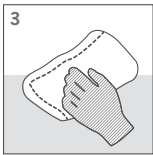

3 Gently rub the surface with soft damp cloth and check the result

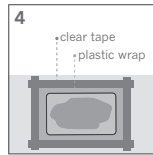

4 If the stain persists, continue to soak with longer time and cover the cotton pad with plastic wrap and clear tape to prevent evaporation (some stubborn stain may need up to 48 hours of soaking)

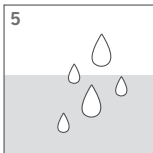

5 After the stain is removed, rinse thoroughly with clean water

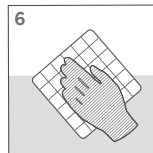

6 Dry with paper towel or soft dry cloth

Remark: During soaking, you can open and check the visibility of stain every couple of hours. After 48 hours, if the stain still remains, please contact our customer service for further assistance.



- DO NOT use high alkaline solution (pH > 10) for soaking method. Instead, please strictly use the cleaning agent as recommended.
- If recommended cleaning agent cannot be found in your area, be sure to test available product on small area of GEOLUXE®'s surface before use.

7. OUTDOOR STAIN

Tools and methods of cleaning outdoor stains are the same as stated in Food stain removal. Just try with simple step first, followed by advanced step if the stains are persistent. An outdoor stain might be probably more difficult to remove due to its accumulation under the weather condition. Periodic check and clean could be helpful to make it easier. Choice of cleaning agent depends on type of stains as below.

Tannin from fermented leaves, fruit and bird droppings





Recommended cleaning agent: Multi-purpose Cleaner (e.g. Mr.Clean: Multi-purpose cleaner, Vixol Oxy)

Hard water stain from rainwater

Recommended cleaning agent: Acid detergent (e.g. Zep: Calcium, Lime and Rust Stain Remover)



In case that you do not know which type of stain exactly, please see the guideline how to check type of stain below.

Visual inspection		Stain type	Cleaning agent
	Colored or dark stains unable to feel by touch	Food & soap stains	Multi-purpose cleaner
	Thin white or brown mark sometimes able to feel by touch	Limescale, hard water stains and rust mark	Acid detergent
	Grey line	Metal mark	Metal polish cream/ Liquid
	Thick stain unable to be removed with water	Grease, candle wax, epoxy and paraffin	Epoxy grout haze & coating stripper

■ RECOATING

To maintain the best staining resistance performance, we suggest recoating your GEOLUXE® countertop every 5 years (depending on the usage). This should be done properly by the professionals following our instruction manual.

Tools and chemical

- > Small containers for preparing coating agent
- > Soft microfiber cloths
- > Gloves for your protection
- > Quartz Toner by TENAX solvent-based stain protector for polished surfaces

INSTRUCTION

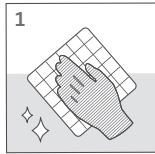

Clean the surface with dry microfiber cloth to make sure that the surface is free from dirt and **completely DRY**. Moisture on the surface during applying can reduce the protecting performance.

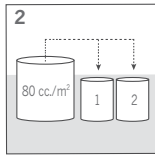

Prepare 80cc./m² of coating agent and divide it into 2 equal portions for applying 2 times.

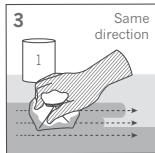

Pour the first portion of coating agent on clean microfiber cloth. Apply it evenly all over GEOLUXE® surface in the same linear direction. Make sure that surface area are all wet.

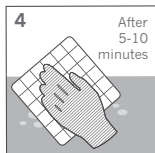

Leave it dry for **5-10 minutes** until glass-like film is noticeably formed, and then start buffing to remove residues with a clean microfiber cloth.

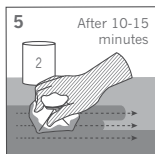

Leave it dry again about **10-15 minutes**, and repeat step 3 and 4 using the other portion to apply for second layer.

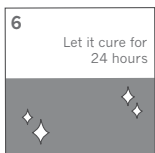

Let it cure for **24 hours** before use to regain the technical properties as original.

■ CHIP REPAIR

The following steps explain how to repair a chipped edge which may occur unintentionally during daily household use. Please note that it is not a perfect repair since it is quite difficult to match the tonality and texture of the surface exactly with epoxy resins. It is recommended to contact your local fabricator to handle the chip repair following our instruction manual.

Tools and chemicals

- > Color-matched adhesive
- > Adjustable speed polishing machine
- > Polishing pad grit number 500, 800, 1000, 2000, 3000
- > Soft microfiber cloths
- > Quartz Toner by Tenax solvent-based stain protector for polished surfaces

INSTRUCTION

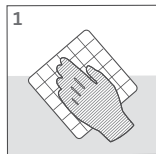

1 Clean and free the chip from loose particles.

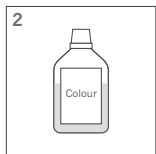

2 Select the appropriate color-matched adhesive.

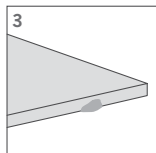

3 Fill the chipped area with adhesive, take out the excess then let it dry for at least **10 minutes**.

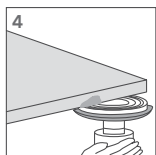

4 Once the adhesive is hardened, grind down the excessive adhesive on the edge using polishing machine attached with polishing pad, the surface repairs are best ground down gently and manually from low grit number to high grit number.

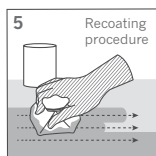

5 Recoat the repaired area following the Recoating instruction mentioned earlier.

■ SCRATCH REMOVAL

Polished surface: Hairline scratch only on polished surface can be removed by professionals using GEOLUXE® scratch removal kit. Please contact your local distributor for more information.

HAIRLINE SCRATCH REMOVAL METHOD FOR POLISHED SURFACE

There are 2 procedures; first REMOVING the hairline scratch followed by PROTECTING the repaired area to enhance the stain resistance. Please note that the degree of glossiness might be slightly different from the original.

REMOVAL

Tools and equipment

> Electrical and cleaning tools

- Adjustable speed polishing machine with 4" Velcro backing pad
- Soft and clean cloth
- Mild detergent
- Spill out barrier (made of corrugated plastic sheet)

> GEOLUXE® Scratch Removal Kit

- White Pad
- GEOLUXE® Light or Dark Colored Restoration Solution (based on surface color)
- Restoration Pad

INSTRUCTION

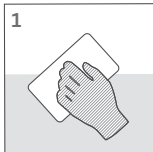

Clean the scratched or polished area using mild detergent and rub the surface gently with White Pad to remove dirt. Wipe out the remaining detergent then rinse well with clean water until all the residues on the surface are removed. Finally, wipe out the water with dry cloth and let the surface dry.

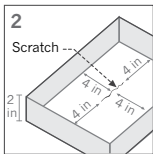

Place spill out barrier at least 4 inches from the edge of the scratched/polished area in all directions, in order to prevent surrounding area from splashes during polishing.

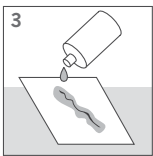

Choose the proper restoration product based on the color of GEOLUXE® surface. Shake the bottle well before use.

- For white or light colored surface, use GEOLUXE® Light Colored Restoration Solution
- For black or dark colored surface, use GEOLUXE® Dark Colored Restoration Solution

When surface is completely dried, apply GEOLUXE® Restoration Solution on the scratched area. (Do not dilute it with water)

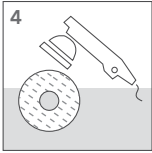

Attach Restoration Pad to the polishing machine. Without turning on the polishing machine, distribute the solution on the scratched surface by using Restoration Pad.

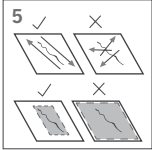

Turn on the polishing machine at 1,500 rpm and start buffing the solution on the surface with linear movements in the same direction of the scratch. Do not apply too much pressure on the tool. Make sure that the Restoration Pad is always parallel to the surface. Only work on the scratched area. Continue polishing until the solution is completely dry.

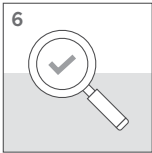

Check the result and repeat step 3 to 5 until the scratch is gone. Generally, 3-5 applications are enough to have an acceptable result.

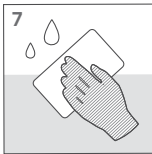

Once the desired result is obtained, rinse well with clean water and rub the surface with White Pad to remove any residues and splashes. Finally, wipe the surface with dry microfiber cloth. If some stubborn residues are still visible on the surface, buff them with a dry Restoration Pad without using any solution.

PROTECTION

Tools and chemical

- > Small containers for preparing coating agent
- > Soft microfiber cloths
- > Gloves for your protection
- > Quartz Toner by TENAX solvent-based stain protector for polished surfaces

INSTRUCTION

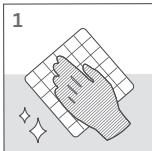

Clean the surface with dry microfiber cloth to make sure that the surface is free from dirt and completely DRY. Moisture on the surface during applying can reduce the protecting performance.

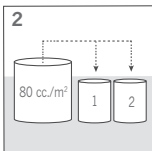

Prepare 80cc./m² of coating agent and divide it into 2 equal portions for applying 2 times.

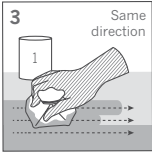

Pour the first portion of coating agent on clean microfiber cloth. Apply it evenly all over GEOLUXE® surface in the same linear direction. Make sure that surface area are all wet.

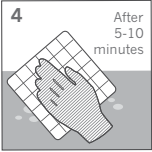

Leave it dry for **5-10 minutes** until glass-like film is noticeably formed, and then start buffing to remove residues with a clean microfiber cloth.

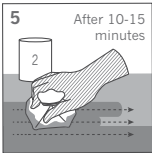

Leave it dry again about **10-15 minutes**, and repeat step 3 and 4 using the other portion to apply for second layer.



Let it cure for **24 hours** before use to regain the technical properties as original.



YOUR HEALTH & HYGIENE ARE OUR CONCERNS



GEOLUXE® was designed and created to be a safe and eco-friendly product for users and their quality time spent together at home. The prestigious beauty integrated with sanitation and good social responsibility was well-recognized and certified by the world-renown institutes like Greenguard and NSF.



Greenguard is the international standard for interior products and materials that have low chemical emissions, improving the quality of the air where the products are used.



NSF/ANSI 51 is the international standard that certifies food equipment materials and finishes, and ensures they are designed and constructed in a way that promotes food safety.



Now you are ready to get started. Please enjoy it with confidence and pride that you made the right choice for the safe and healthy space, not only at your own home but also our shared environment.

We are always at full disposal to take care of customers like our family members. Should you have any inquiry, please contact your local GEOLUXE® dealer or contact info@geoluxe.com.

We would be delighted to assist for your living with the peace of mind.

info@geoluxe.com | www.geoluxe.com

